



Fulbrook Lane, Sherbourne,
Warwick, CV35 8AR, ENGLAND

Tel: 01926 624800

Fax: 01926 624900

MICRO SYSTEM RADIO/POWER INTERFACE UNIT

LARGE POWER FILTER (A TYPE)

REF: E003-2 01-08-97

INSTALLATION INSTRUCTIONS

WARNING:

Connection to voltage supplies other than 12Volts DC, or incorrect polarity connection, will damage the filter and may cause a fire.

The Large Power Filter should only be connected to a 12Volt battery and must never be connected directly to a voltage regulator.

When connecting the red input lead, a fuse must also be installed in-line (10 Amp Fuse Maximum) to protect the lead in the event of a short circuit.



Be sure to observe all standard electrical precautions during the installation of the power filter.

CONNECT THE BLUE OUTPUT LEAD TO THE POSITIVE TERMINAL OF THE EQUIPMENT TO BE SUPPLIED AND THE BLACK OUTPUT LEAD TO THE NEGATIVE TERMINAL.

BLACK LEAD - NEGATIVE

RED LEAD + POSITIVE

OUTPUT

BLACK LEAD - NEGATIVE

BLUE LEAD + POSITIVE

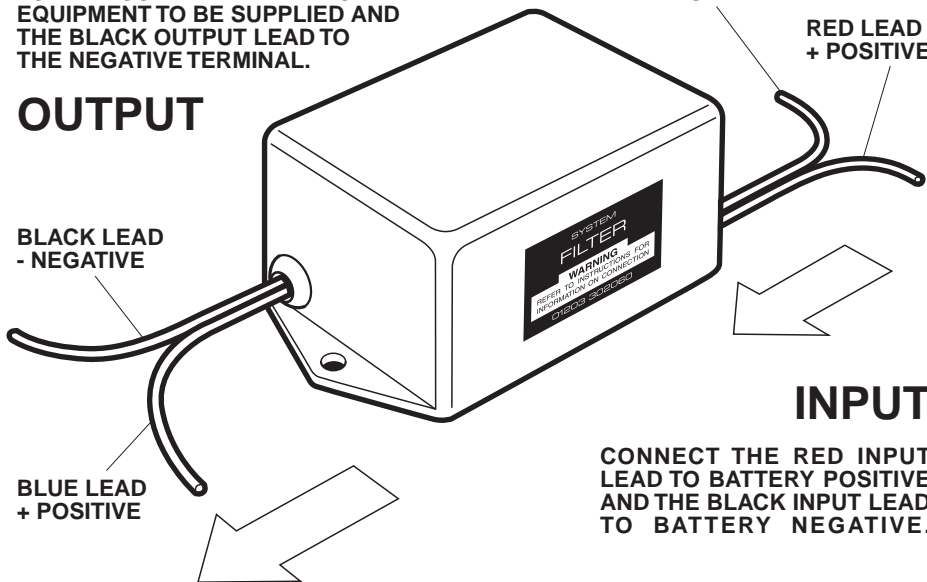

INPUT

CONNECT THE RED INPUT LEAD TO BATTERY POSITIVE AND THE BLACK INPUT LEAD TO BATTERY NEGATIVE.

IMPORTANT

READ THIS INFORMATION CAREFULLY BEFORE ATTEMPTING TO USE THIS ITEM OF EQUIPMENT